

# HASSELBLAD

## Film Magazines

A12 - 6x6

A16 - 645

A24 - 6x6

A32 - 645

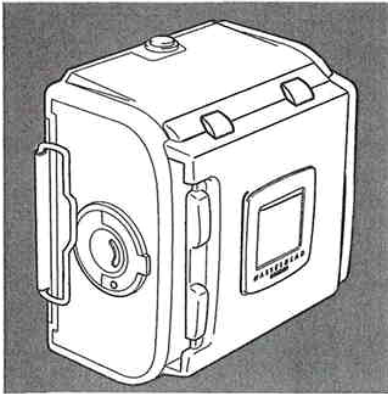

*Instruction Manual, Gebrauchsanweisung, Manual de Instrucciones,  
Manual d'Instructions, Manuale d'Istruzioni,  
Gebruiksaanwijzing, Bruksanvisning*

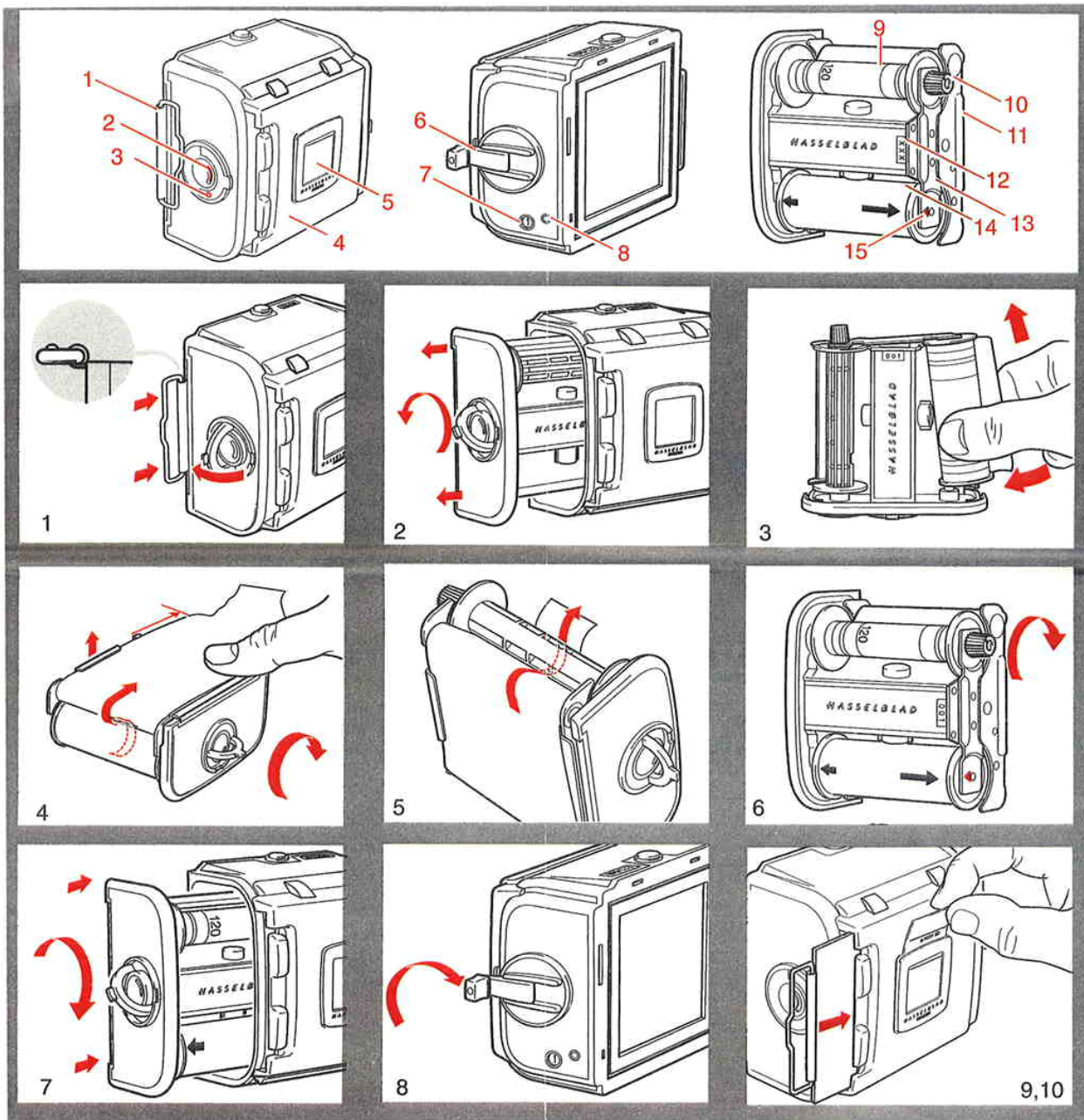

The Magazines A12, A16, A24 and A32 are completely mechanical. They have essentially the same design and functions and only differ with regard to film type, format and number of exposures per film.

### Parts & Components

1. Magazine slide	9. Film take-up spool
2. Film load indicator	10. Grooved take-up knob
3. Film holder key	11. Film clamp
4. Magazine slide holder	12. Film holder number
5. Film tab holder	13. Spool clamp bar
6. Film winder crank	14. Film supply spool
7. Frame counter	15. Film load index
8. Film advance indicator	

### Magazine Operation

Operation of the magazines is not difficult but please pay particular attention to the section on loading. Note especially which way round the roll of film is placed and the positioning of the backing paper under the clamp bar.

The magazine can be loaded on, or off the camera but if it is to be loaded off the camera, then the magazine slide must be inserted first. In either case, when inserting the slide ensure that its flat side is towards the rear (see detail in illustration) as this facilitates the removal of the film holder.

Check the status of the magazine before attaching it to a camera. If the magazine status indicator window shows white, the magazine can be used immediately. If it shows red, then a new film frame must be advanced by firstly attaching the magazine to a released camera and secondly winding the camera, bringing both camera and magazine into synchronized ready status.

### Step-by-step loading

1. Fold out the film holder key.
2. Turn the key counter-clockwise and withdraw the film holder.
3. Place an empty take-up spool under the grooved knob of the spool clamp bar. Insert a roll of film under the other end of the bar, turned the same way as in the illustration. Be sure to remove all of the paper band surrounding a new roll of film.
4. Turn the film holder key clockwise to open the film clamp. Pull 8-10 cm (3 - 4 in.) of paper backing off the film roll and slide the edge under the clamp.
5. Insert the tongue of the backing paper into the slot in the take-up spool.
6. Turn the grooved knob clockwise until the arrow on the paper backing is aligned opposite the triangular index on the spool clamp bar, but no further.
7. Turn the film holder key counter-clockwise and insert the film holder into the magazine. Ensure that it is correctly positioned. Turn the film holder key clockwise to lock the film holder in the magazine and then fold the key back into place.
8. Fold out the film crank and rotate it clockwise about ten turns until it stops. Then turn it counter clockwise and fold it in. The figure (1) will now be displayed in the automatic frame-counter window indicating that the magazine is loaded and ready for use.
9. The end tab of the film pack can be inserted in the holder on the back of the magazine as a reminder of the kind of film that has been loaded into the magazine.
10. To avoid misplacing the magazine slide, insert it into the magazine slide holder after removal, and fold the grip back into the recess provided.

### General Remarks

- The magazine's film winding crank is only blocked for the first frame. A partially exposed film may be wound off at any frame afterwards.
- In the centre of the film holder key there is a crescent-shaped film load indicator window that has a white display when the magazine is freshly loaded. The display gradually changes to red as the film is wound through. An all red indicator shows that either the film is used up or that the magazine is empty.
- When the last frame has been exposed and wound on, the magazine blocks the camera for further release. Wind off the film by folding out the film winding crank, and rotate it clockwise until you can feel the film leaving the supply spool. You can now withdraw the film holder from the magazine and remove the exposed film.
- The frame counter is automatically reset when the film holder is withdrawn from the magazine.
- Each magazine housing and film holder form a carefully matched pair. Be careful, therefore, when loading more than one magazine at a time not to switch housings and holders. The last three figures of the housing serial number should correspond with the serial number on the film holder.
- Load and unload the magazine away from direct light sources.
- Do not put the film holder down on an unclean surface or where it can attract dust. Clean out the magazine housing regularly removing not only dust and particles but also any scraps of paper from previous rolls of film that may have remained inside.

	Film type,	Format,	Exposures per film,
<b>A12</b>	120	6 x 6 cm (2 <sup>1</sup> / <sub>4</sub> x 2 <sup>1</sup> / <sub>4</sub> " )	12
<b>A16</b>	120	6 x 4.5 cm (2 <sup>1</sup> / <sub>4</sub> x 1 <sup>5</sup> / <sub>8</sub> " )	16
<b>A24</b>	220	6 x 6 cm (2 <sup>1</sup> / <sub>4</sub> x 2 <sup>1</sup> / <sub>4</sub> " )	24
<b>A32</b>	220	6 x 4.5 cm (2 <sup>1</sup> / <sub>4</sub> x 1 <sup>5</sup> / <sub>8</sub> " )	32